

SV08 EWL

The AICHI SV08 EWL scissor lift reaches a maximum working height of 9.92 m and is suitable for indoor and outdoor use with a maximum load capacity of 450 kg or 120 kg.



Control System

The simple controls allow easy operation.



One-sided

Platform extension

0.90 meter platform extension on one side with max. 120 kg load capacity.



Full height movable

Enables efficient working even in rough terrain.

Technical details

Max. Working height	9.92 m
Platform extension	1.27 m
Load capacity	450 kg
Load capacity on platform extension	120 kg
Platform size L x W x H	2.41 x 1.04 x 1.11 m
Engine	Batterie 4x6 V 185 Ah

Max. Speed	0.8 km/h / 4 km/h (0.49 mph / 2.48 mph)
Min. Transportation dimension L x W x H	2.69 x 1.17 x 1.99 m
Total weight	2,770 kg
Max. Height during the procedure	9.92 m
Max. Longitudinal/ transverse inclination	3° / 2°
Max. Gradability	14°

SV08 EWL

Technical details

Max. Working height	9.92m
Max. Platform height	7.92 m
Platform extension	1.27 m
Max. Platform load capacity	450 kg / 2 Persons (Platform extended indoor) 120 kg / 1 Person (Platform extended outdoor)
Load capacity platform extension	120 kg / 1 Person
Max. Height during the procedure	9.92 m
Max. Transportation dimension L x W x H	2.50 x 1.17 x 2.33 m
Min. Transportation dimension L x W x H	2.69 x 1.17 x 1.99 m
Lifting time (unloaded)	32 - 48 econds
Lowering time	40 - 60 seconds
Total weight	2,770 kg
Max. Gradability	14°
Control system	Proportional control system

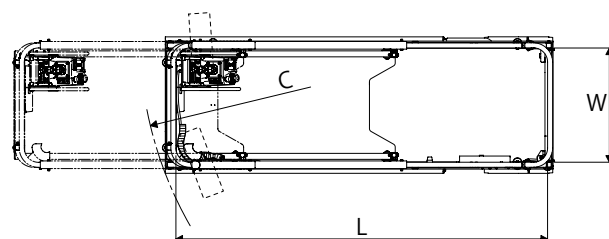
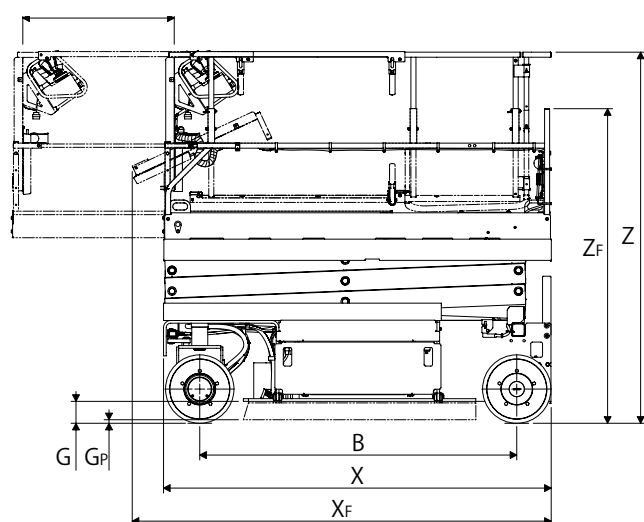

Engine

Engine	Battery
Battery pack	24 V / 185 Ah
Battery charger	24 V / 25 A

Features

Standard features:

- Bright and non-marking tires
- Multifunction display
- Extendable platform
- Ground control
- Indicator lights Charger
- Folding railing

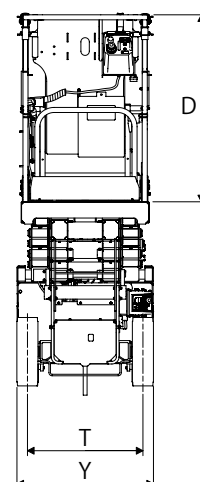

C	2.58 m
L	2.41m
W	1.04 m
E	1.27 m
G	130 mm
Gp	20 mm
B	2.08 m
X	2.50 m
XF	2.69 m
ZF	1.99 m
Z	2.33 m
D	1.11 m
T	1.05 m
Y	1.17 m